

A modern, multi-story office building with a grey facade and large glass windows. The ground floor features a prominent teal-colored entrance structure with a glass door. The building is set against a clear blue sky. The foreground shows a paved area and a metal fence.

# 123

WINTERSTOKE ROAD  
BRISTOL, BS3 2LL

---

**GRADE A  
OFFICES  
TO LET**

40,813 sq ft  
(3,791.6 sq m)

---





Large terrace



Shower facilities  
(6 no.)



Ground floor  
**café**



**80**  
Car parking spaces

---







## DESCRIPTION

123 Winterstoke Road comprises an office building designed by AWW, which has been fully reconstructed, retaining original elevations in part and completed in 2014. The building is BREEAM 'Very Good' and has been fitted out to a high standard. 123 Winterstoke Road provides the following specification:

- Suspended ceilings
- Full access raised floors
- Four pipe fan coil air conditioning
- LPHW wet underfloor heating system in part
- Photovoltaic (PV) Panels
- LG7 recessed modular lighting with daylight sensors and PIRs
- Large terrace with views of the surrounding countryside
- Ground floor café
- Passenger lift (10 person 800 Kg)
- Male, female and disabled WCs on each floor
- Shower facilities (6 showers)
- 80 car parking spaces (1 space per 510 sq ft)
- Secure bicycle racks
- On-site nursery

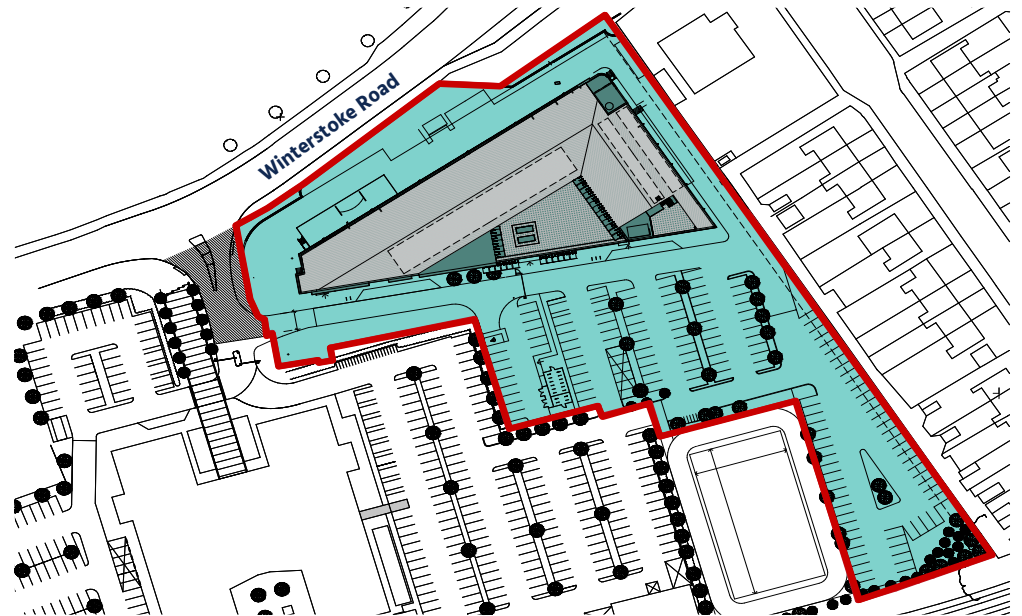



## LOCATION

123 Winterstoke Road is accessed off the A370 and lies just to the south west of the city centre, which is a 5 minute drive away.

The building sits on the M2 Metrobus route and is 13 minutes from Temple Meads Railway Station, only 6 minutes from Wapping Wharf and all the amenity and leisure facilities it has to offer.

Other nearby occupiers include Imperial Brands, Midas, Stone & Co Accountants, Computershare, Babcock, David Lloyd Clubs, Royal Navy, Bristol City Football Club and Sainsbury's Superstore & Petrol Station.

Vibrant North Street, with its plethora of independent shops, bars, and restaurants, including the Tobacco Factory, is within a 10 minute walk.

The Bristol Sport complex opposite, offers a vast array of facilities for business and pleasure, including conference / meeting facilities, restaurants and bar.

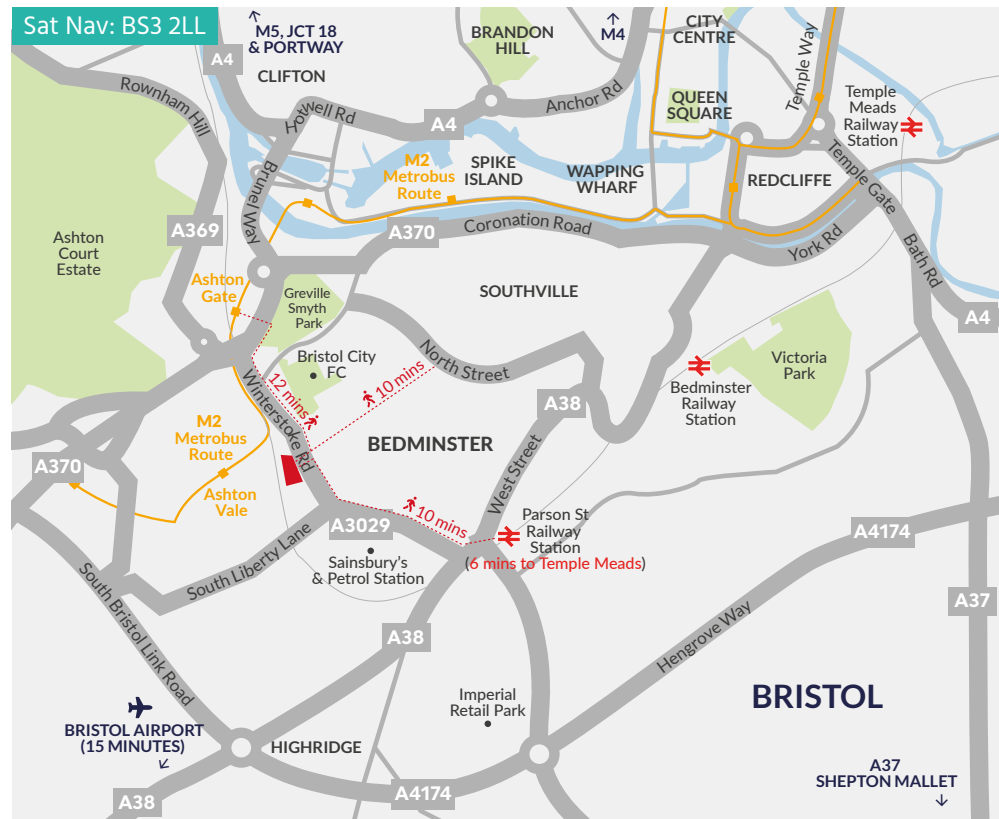





Bristol Temple Meads Railway Station

Queen Square

Harbourside

Clifton Suspension Bridge

Clifton

Tobacco Factory

North Street Bedminster

Ashton Court Estate

Greville Smyth Park

M2 Metrobus Ashton Gate

Bristol City Football Club

A370

Winterstoke Road A3029

123

Manheim Bristol Auction

M2 Metrobus Stop Ashton Vale

Sainsbury's Superstore and Petrol Station



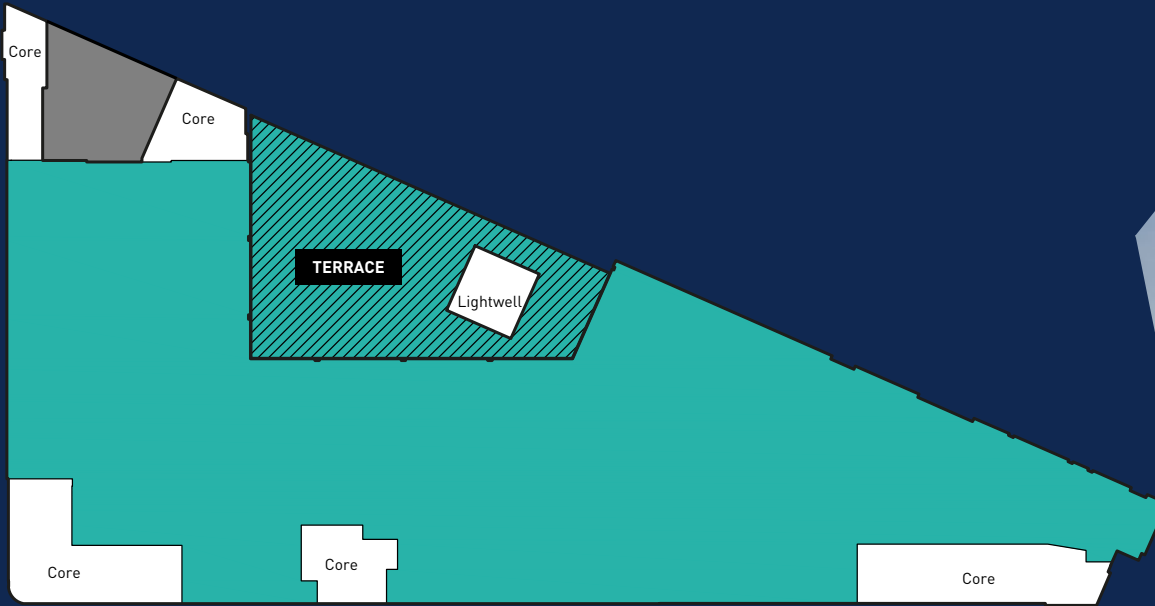

First Floor

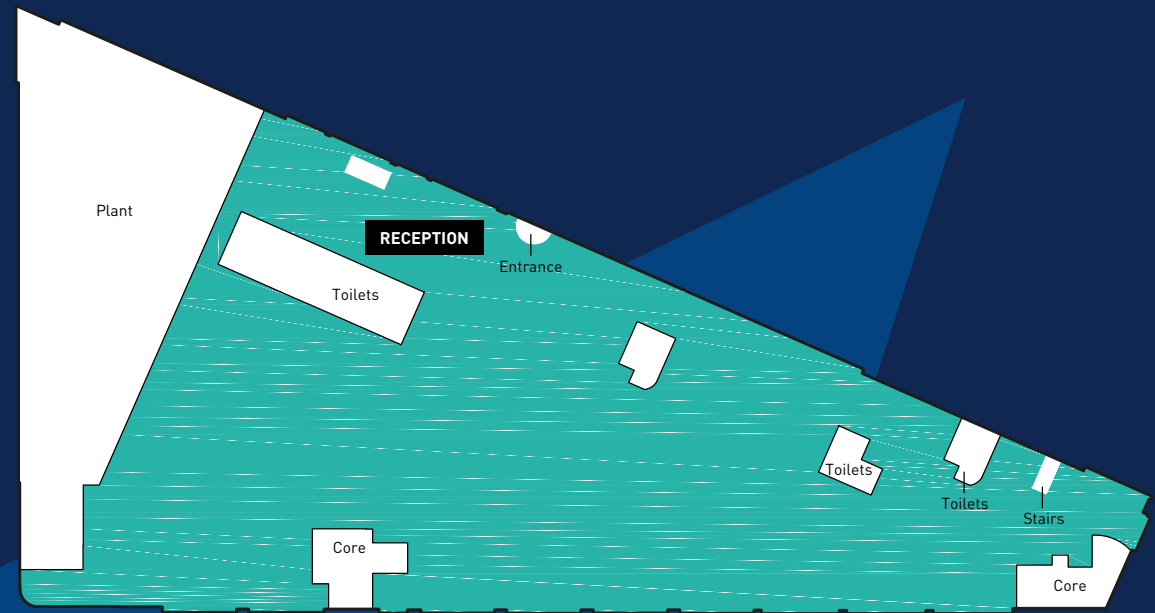

Ground Floor





## ACCOMMODATION

The property has been measured in accordance with the RICS Code of Measuring Practice (6th Edition) on an NIA basis and provides the following floor areas.

| Floor                    | SQ FT         | SQ M           |
|--------------------------|---------------|----------------|
| First Floor - Office     | 21,506        | 1,998.0        |
| Ground Floor - Office    | 18,680        | 1,735.4        |
| Ground Floor - Reception | 627           | 58.2           |
| <b>Total</b>             | <b>40,813</b> | <b>3,791.6</b> |

This is the largest self-contained building currently available in the Bristol office market, offering excellent accommodation that is only 4 years old. A high quality fit out is available, that will reduce any incoming tenants fit out cost.



Photovoltaic  
(PV) Panels



High  
quality tenant  
fit out



Large  
open plan  
floor plates



Secure  
bicycle  
racks



Four pipe  
fan coil  
air conditioning



Passenger lift  
(10 person  
800 Kg)

### Tenure

The office space is available to let by way of a fully repairing and insuring sublease expiring on 24th September 2028. Full terms are available upon application.

### Rent

£27.50 psf.

### Business Rates

We advise that interested parties make their own enquiries through the local authority (Bristol City Council).

### EPC

C55

### Car Parking

80 car parking spaces. This provides a parking ratio of 1 space per 510 sq ft.

### VAT

All figures quoted are exclusive of VAT where applicable.

### Legal Costs

Each party to be responsible for their own legal and professional fees incurred in the transaction.

---

## VIEWING & FURTHER INFORMATION

For further information or for an appointment to view, please contact the joint sole agents:

Embassy House  
Queens Avenue  
Bristol, BS8 1SB



**savills.com**  
**0117 910 2200**

#### Harry Allen

0117 910 2356

Hrallen@savills.com

#### Chris Meredith

0117 910 2216

Cmeredith@savills.com



**0117 910 6699**  
cushmanwakefield.co.uk

#### Seonaid Butler

0117 910 5269

Seonaid.butler@cushwake.com

#### Andy Heath

0117 910 5268

Andy.heath@cushwake.com

Visit the website for the current availability

**WWW.123WINTERSTOKEROAD.co.uk**

---

IMPORTANT NOTICE - Savills, their clients and any joint agents give notice that:

They are not authorised to make or give any representations or warranties in relation to the property either here or elsewhere, either on their own behalf or on behalf of their client or otherwise. They assume no responsibility for any statement that may be made in these particulars. These particulars do not form part of any offer or contract and must not be relied upon as statements or representations of fact. Any areas, measurements or distances are approximate. The text, images and plans are for guidance only and are not necessarily comprehensive. It should not be assumed that the property has all necessary planning, building regulation or other consents and Savills have not tested any services, equipment or facilities. Purchasers must satisfy themselves by inspection or otherwise. These particulars were prepared from preliminary plans and specifications before the completion of the properties. These particulars, together with any images that they contain, are intended only as a guide. They may have been changed during construction and final finishes could vary. Prospective purchasers should not rely on this information but must get their solicitor to check the plans and specification attached to their contract. March 2019